

**CUSHMAN &
WAKEFIELD**
Atlantic



FOR LEASE

**679-695 MAIN STREET
MONCTON, NEW BRUNSWICK**

+/- 1,246 – 6,902 SF

HIGGINS BLOCK

77 Vaughan Harvey Boulevard
Suite 402 Moncton, New Brunswick
+1 506 387 6925
cwatlantic.com

FOR LEASE

HIGGINS BLOCK

679-695 Main Street | Moncton, New Brunswick

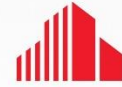

**CUSHMAN &
WAKEFIELD**
Atlantic



+/- 1,246 – 6,902 SF

Property Highlights

679-695 Main Street Moncton, commonly known as the Higgins Block, consists of a 3-storey Italianate commercial building in pink sandstone, located on the northwest corner of Botsford Street and Main Street in Moncton.

- Space available: 2nd & 3rd floors
- Lease Rate: \$17.00 psf net
- Additional Rent: \$14.00 psf
- Tenant Incentive Allowance* \$25.00 psf
- All units are vacant and ready for tenant's design
- Plenty of natural light through large floor-to-ceiling windows
- Access to the city transit route and stops
- Elevator access available

*Subject to lease terms



Contact

ADAM MAGEE
Senior Associate
+1 506 387 6928
amagee@cwatlantic.com

JAMIE SMITH
Commercial Real Estate Associate
+1 506 387 4169
jsmith@cwatlantic.com

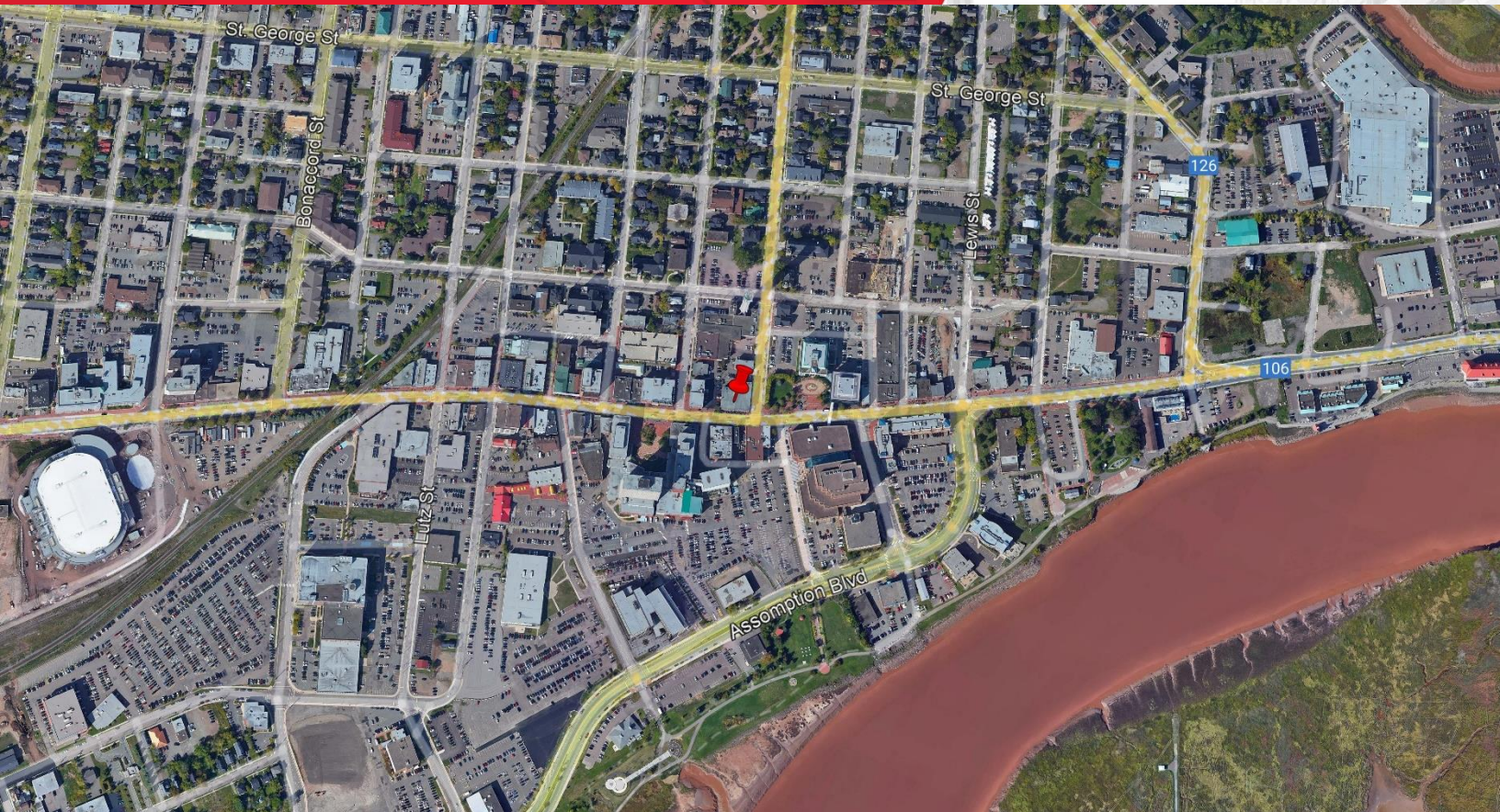

Additional Property Information

The building is a 3-storey commercial heritage building with a 9,693 ft² basement and 29,079 ft² above grade, with 16 dedicated parking spaces in the back of the building. The building is a heritage building built in 1901, with an addition in 1908. The walls of the building are brick and sandstone.

Area Amenities

- Walking distance from hotels, Assumption Place, banks, city hall, restaurants, coffee shops, and the Avenir Centre.
- 20,000+ downtown business population
- Public and private parking easily accessible
- 3,000+ bar & restaurant seats in the downtown core
- Minutes from Wheeler Boulevard

Contact

ADAM MAGEE
Senior Associate
+1 506 387 6928
amagee@cwatlantic.com

JAMIE SMITH
Commercial Real Estate Associate
+1 506 387 4169
jsmith@cwatlantic.com

FOR LEASE

HIGGINS BLOCK

679-695 Main Street | Moncton, New Brunswick

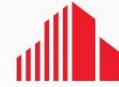

**CUSHMAN &
WAKEFIELD**
Atlantic



Space Available

Suite Number	Square Footage	Price (NET)	Virtual Tour
204	1,482	\$17.00	Higgins Suite 204
211	1558	\$17.00	Higgins Suite 211
305	1,484	\$17.00	Higgins Suite 305
308	1,263	\$17.00	Higgins Suite 308
310	1,292	\$17.00	Higgins Suite 310

Contact

ADAM MAGEE
Senior Associate
+1 506 387 6928
amagee@cwatlantic.com

JAMIE SMITH
Commercial Real Estate Associate
+1 506 387 4169
jsmith@cwatlantic.com

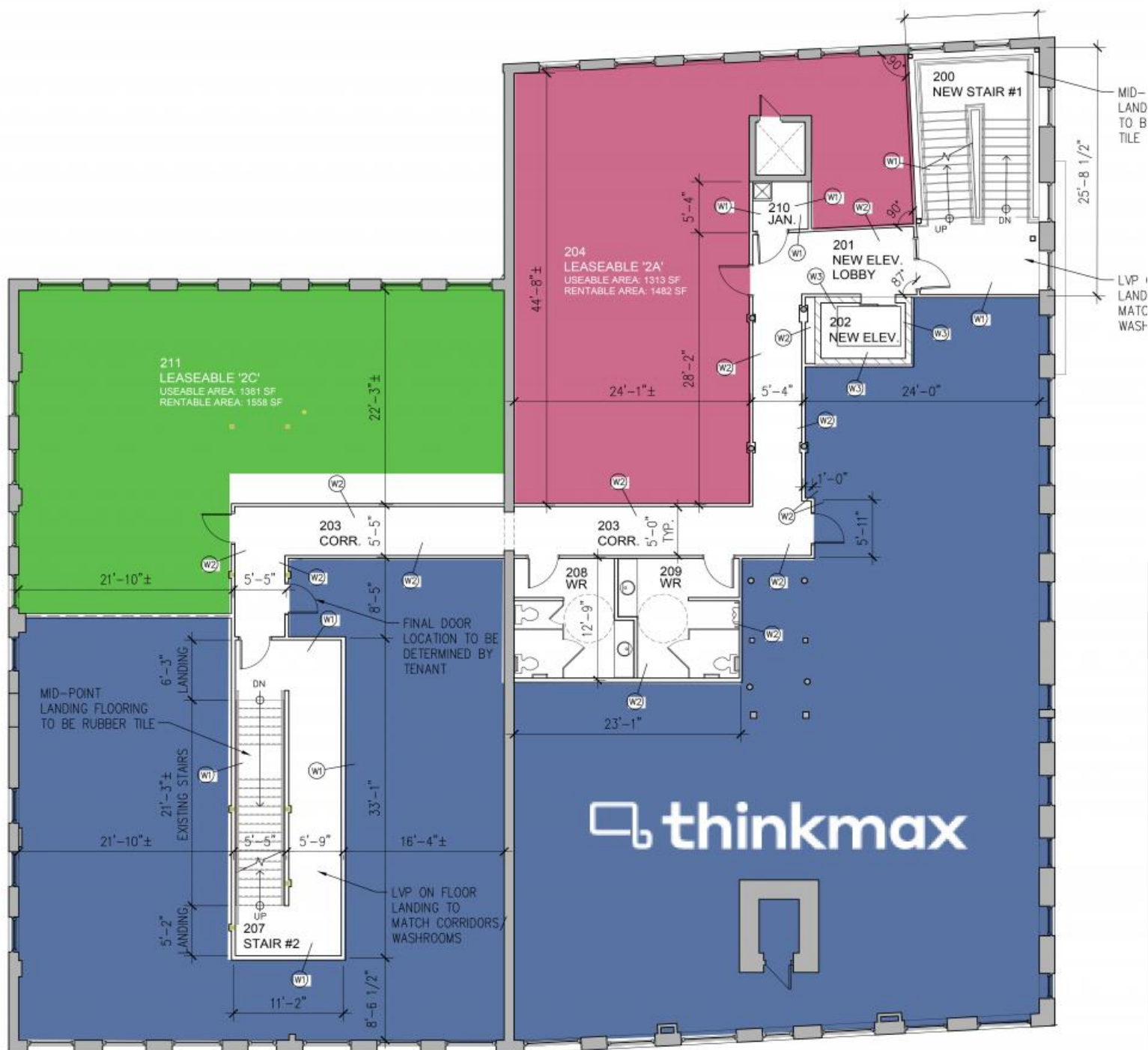

Contact

ADAM MAGEE
Senior Associate
+1 506 387 6928
amagee@cwatlantic.com

JAMIE SMITH
Commercial Real Estate Associate
+1 506 387 4169
jsmith@cwatlantic.com



Contact

ADAM MAGEE
Senior Associate
+1 506 387 6928
amagee@cwatlantic.com

JAMIE SMITH
Commercial Real Estate Associate
+1 506 387 4169
jsmith@cwatlantic.com