

MONTHLY LISTINGS REPORT

Nova Scotia | November 2021

FOR LEASE

OFFICE SPACE FOR LEASE

INDUSTRIAL SPACE FOR LEASE

COMMERCIAL/RETAIL SPACE FOR LEASE



OFFICE SPACE FOR LEASE

CLICK ON THE PHOTO TO OBTAIN MORE INFORMATION ONLINE



3 SPECTACLE LAKE DRIVE, DARTMOUTH

Size	1,971 sf	Details	Professional office space for sub-lease with an expiry of June 30, 2024 .
Price	Please Contact	Agent(s)	Mike Vaughan



2717 JOSEPH HOWE DRIVE, HALIFAX

Size	10,198 sf	Details	Professional Class A office space in two tower office complex.
Price	\$14.00 psf Net	Agent(s)	Bill MacAvoy



BLUEFROG CAMPUS, 120, 130 & 134 EILEEN STUBBS, DARTMOUTH

Size	Up to 14,583 sf	Details	Various spaces in the Bluefrog Campus with lots of common amenities.
Price	Please Contact	Agent(s)	Alec Cranston



120 EILEEN STUBBS, DARTMOUTH

Size	Up to 23,000 sf	Details	Ground and second floor office space in the Bluefrog Business Campus.
Price	\$20.00 psf Gross	Agent(s)	Bill MacAvoy



2737 JOSEPH HOWE DRIVE, HALIFAX

[VIEW 360 TOUR](#)

Size	22,000 sf	Details	Large modern office space with kitchen and many small breakout rooms.
Price	Please Contact	Agent(s)	Bill MacAvoy



5475 SPRING GARDEN ROAD, HALIFAX

Size	820 - 4,460 sf	Details	Multiple units available, sweeping views. Quiet well-maintained building.
Price	\$16.00 psf Net	Agent(s)	Alec Cranston

OFFICE SPACE FOR LEASE

CLICK ON THE PHOTO TO OBTAIN MORE INFORMATION ONLINE



5226 ST. MARGARETS BAY ROAD, TANTALLON

Size	1,705 sf	Details	Bright 2 nd floor space, located at main intersection, with ample parking.
Price	Negotiable	Agent(s)	Steven Dexter



2625 JOSEPH HOWE DRIVE - UNIT 12 , 23 & 24, HALIFAX

Size	1,656, 677 & 2,435 sf	Details	On the Armdale Rotary, on-site parking includes interior suite cleaning.
Price	Starts \$14.50 psf Net	Agent(s)	Steven Dexter

INDUSTRIAL SPACE FOR LEASE

CLICK ON THE PHOTO TO OBTAIN MORE INFORMATION ONLINE



90 HIGNEY AVENUE, DARTMOUTH		VIEW 360 TOUR	
Size	Up to 14,750 sf	Details	New construction mixed-use commercial space. Already 50% leased!
Price	\$14.00 psf Net	Agent(s)	James Collins Steven Dexter



MONAGHAN SQUARE, 6140 YOUNG STREET, HALIFAX			
Size	913 sf	Details	Ground floor industrial style space with high ceilings in retail plaza.
Price	Please Contact	Agent(s)	Jamie Ferguson

COMMERCIAL/RETAIL SPACE FOR LEASE

CLICK ON THE PHOTO TO OBTAIN MORE INFORMATION ONLINE



589 PRINCE STREET, TRURO

Size	+/- 2,400 sf	Details	Two-storey open concept space with high ceilings and rubber floors.
Price	\$15.00 psf Net	Agent(s)	Mike Vaughan



1333 SOUTH PARK STREET, HALIFAX

Size	9,551 sf	Details	Spacious ground floor retail off of a high traffic street downtown.
Price	\$16.00 psf Semi-Gross	Agent(s)	Alec Cranston



857 SACKVILLE DRIVE, LOWER SACKVILLE

Size	1,810 sf	Details	Open concept space with concrete floors, natural light and high ceilings.
Price	\$18.00 psf Net	Agent(s)	Steven Dexter



2700 ROBIE STREET, HALIFAX

Size	+/- 8,500 sf	Details	1 st floor retail/showroom and warehouse space with 2 nd floor office.
Price	Please Contact	Agent(s)	Jamie Ferguson



585 SACKVILLE DRIVE, HALIFAX

Size	5,300 sf	Details	Open concept space with excellent visibility and direct walk up entry.
Price	\$15 Gross psf/Annum	Agent(s)	Jamie Ferguson



6140 QUINPOOL ROAD, HALIFAX

Size	1,000-3,750 sf	Details	Ground floor and lower-level retail space with barrier free access.
Price	\$30.00 psf Gross	Agent(s)	Alec Cranston

COMMERCIAL/RETAIL SPACE FOR LEASE

CLICK ON THE PHOTO TO OBTAIN MORE INFORMATION ONLINE



1881 BRUNSWICK STREET, HALIFAX

Size	2,500 sf	Details	Floor to ceiling windows, open concept space in a prime location.
Price	\$18.00 psf Net	Agent(s)	Alec Cranston



1030 SOUTH PARK, HALIFAX

Size	1,200 sf	Details	Space is a blank canvas. Access to hundreds of tenants living above.
Price	\$22.00 psf Semi-gross	Agent(s)	Alec Cranston



3077-3085 OXFORD STREET, HALIFAX

Size	6,300 sf (demisable)	Details	New retail space under construction with exposure off Oxford Street.
Price	Please Contact	Agent(s)	Jamie Ferguson



THE KEEP, 6112 QUINPOOL ROAD, HALIFAX

Size	3,000 sf	Details	Ground floor retail, busy corner of main arterial road. Only 1 unit left!
Price	\$35.00 psf Net	Agent(s)	Steven Dexter



118 WYSE ROAD, DARTMOUTH

Size	+/- 10,053 sf	Details	Situated in a prime retail area with excellent pedestrian and high traffic.
Price	\$6.00 psf Net	Agent(s)	Alec Cranston

FOR SALE

COMMERCIAL PROPERTIES FOR SALE

INVESTMENT AND LAND FOR SALE



COMMERCIAL PROPERTIES FOR SALE

CLICK ON THE PHOTO TO OBTAIN MORE INFORMATION ONLINE



AWARD-WINNING FOOD & BEVERAGE BUSINESS, HALIFAX

Size	9,000-10,000 sf	Details	Sale is comprised of the building, business, equipment and land parcel.
Price	\$1,500,000	Agent(s)	Alec Cranston



50 ROWLINGS AVENUE, MUSQUODOBOIT HARBOUR

[VIEW 360 TOUR](#)

Size	5 acres	Details	Industrial yard and building on partially cleared lot in the Industrial Park.
Price	\$700,000	Agent(s)	Alec Cranston



626 KING STREET, BRIGEWATER

Size	2,638 sf lot size	Details	Two storey building with ground level retail and residential apartments.
Price	\$1,125,000	Agent(s)	Alec Cranston



30 UPHAM DRIVE, TRURO

[VIEW 360 TOUR](#)

Size	+/- 10,000 sf	Details	Industrial warehouse space with large fenced in yard.
Price	\$590,000	Agent(s)	James Collins



2199 GOTTINGEN STREET, HALIFAX

Size	5,100 sf	Details	Unique property with significant redevelopment potential.
Price	\$899,000	Agent(s)	Mike Vaughan

INVESTMENT PROPERTIES FOR SALE

CLICK ON THE PHOTO TO OBTAIN MORE INFORMATION ONLINE



PICTOU COUNTY MULTI-RESIDENTIAL PORTFOLIO, NEW GLASGOW

Size	46 units/12 properties	Details	Fully rented with waiting list, multi-residential investment portfolio.
Price	\$6,000,000	Agent(s)	James Collins



400 WINDMILL ROAD, DARTMOUTH

Size	136,163 sf density	Details	Multi-residential development opportunity adjacent to Shannon Park.
Price	Please Contact	Agent(s)	Steven Dexter



1675 OXFORD STREET | THE COMMODORE, HALIFAX

Size	26 units/100 beds	Details	Fully rented, 26 unit multi-residential investment with a steady income.
Price	Please Contact	Agent(s)	Steven Dexter

LAND FOR SALE

CLICK ON THE PHOTO TO OBTAIN MORE INFORMATION ONLINE



64 MILL LAKE #2 ROAD, MOUNT UNIACKE

[VIEW 360 TOUR](#)

Size	1.19 acres	Details	Vacant land cleared of all buildings ideally positioned for development.
Price	\$150,000	Agent(s)	James Collins

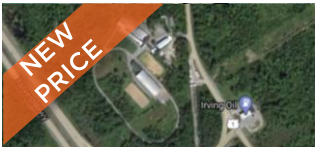

68&70 HIGHWAY 1, MOUNT UNIACKE

[VIEW 360 TOUR](#)

Size	+/- 26 acres	Details	Partially cleared lot with 6 existing buildings and highway visibility.
Price	\$4,999,999	Agent(s)	Steven Dexter James Collins



28875 HIGHWAY 7, MOSER RIVER

Size	2.489 acres	Details	Land on a partially cleared lot with existing building on site.
Price	\$49,000	Agent(s)	Mike Vaughan



11 CENTURY DRIVE, HEBBVILLE

Size	+/- 151 acres	Details	Development land ideal for multi-residential in Hebbville and Bridgewater.
Price	\$339,000	Agent(s)	Mike Vaughan



SOLD & LEASED

A LIST OF PROPERTIES SOLD AND
LEASED BY OUR BROKERAGE TEAM IN
THE LAST 30 DAYS.

SOLD AND LEASED PROPERTIES



106 BLUEWATER ROAD, BEDFORD

Size	2,600 sf	Details	1,400 sf modern designed 2 nd floor office and 1,200 sf industrial space.
		Agent(s)	James Collins



5226 ST. MARGARETS BAY ROAD, TANTALLON

Size	2,065 sf	Details	Bright 1 st floor space, located at main intersection, with ample parking.
		Agent(s)	Steven Dexter



52 ROWLINGS AVENUE, MUSQUODOBOIT HARBOUR

[VIEW 360 TOUR](#)

Size	49,320 sf	Details	Fully fenced industrial yard with 1,200 sf garage and 680 sf office space.
		Agent(s)	Alec Cranston



James Collins
Industrial Leasing & Sales
902 425 1444 Direct
902 489 0015 Mobile
902 425 7374 Fax
jcollins@cwatlantic.com



Alec Cranston
Commercial Real Estate Advisor
902 789 2477 Mobile
902 425 7374 Fax
acranston@cwatlantic.com



Steven Dexter
Vice President
902 425 0377 Direct
902 222 2399 Mobile
902 425 7374 Fax
sdexter@cwatlantic.com



Jamie Ferguson
Commercial Sales & Leasing
902 425 4009 Direct
902 209 5123 Mobile
902 425 7374 Fax
jferguson@cwatlantic.com



Bill MacAvoy
Managing Director
902 425 1872 Direct
902 880 0445 Mobile
902 425 7374 Fax
bmacavoy@cwatlantic.com



Mike Vaughan
Commercial Real Estate Advisor
902 482 2999 Direct
902 452 3692 Mobile
902 425 7374 Fax
mvaughan@cwatlantic.com

cwatlantic.com